

WESTMOUNT AVENUE

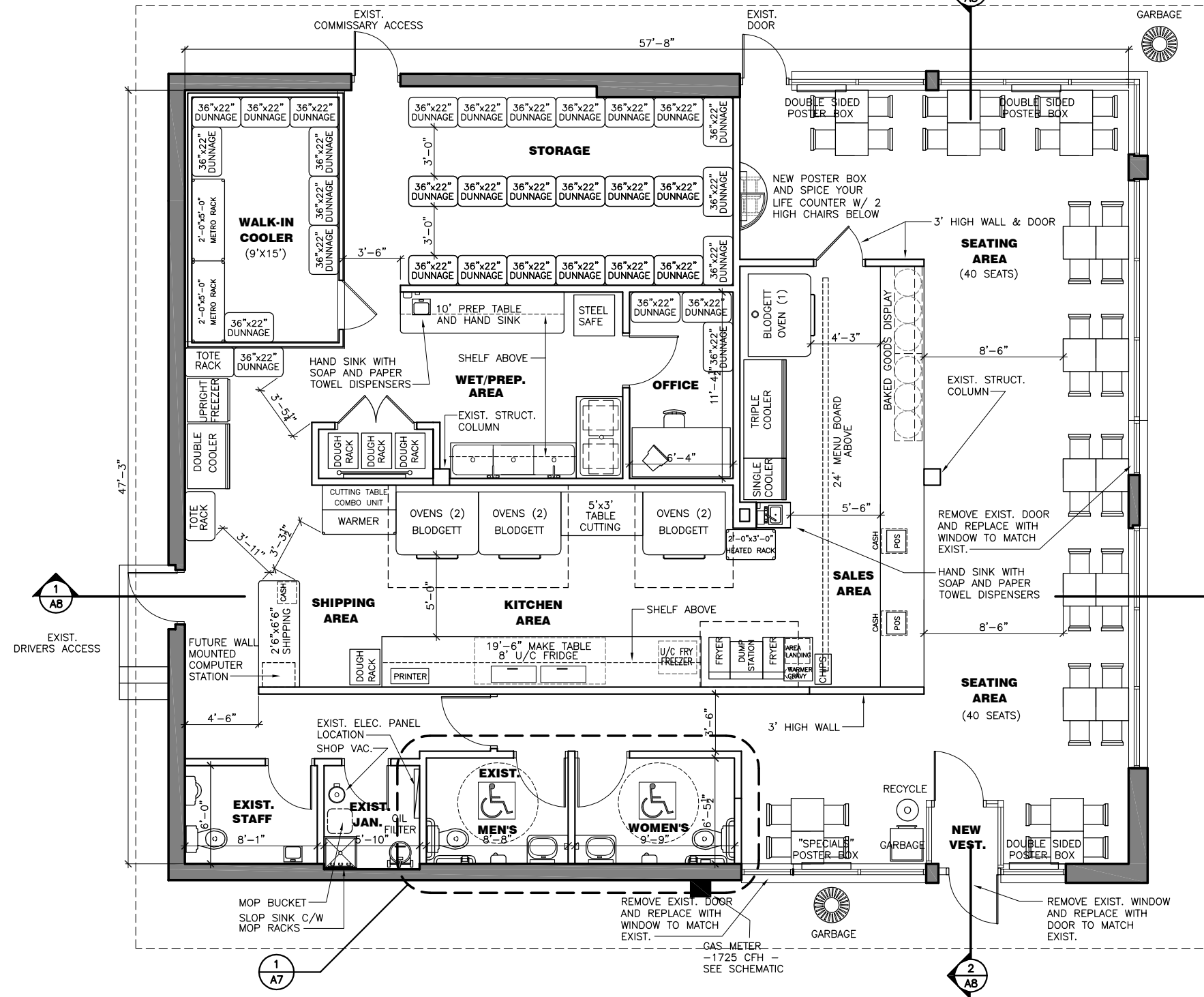
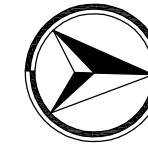

STATISTICS:

SEATING: 40
 DUNNAGE: 25
 TOTES: 2
 WALK-IN COOLER:
 DUNNAGE: 8
 METRO RACKS: 2

AREA CALCULATIONS:

EXISTING PIZZA PIZZA STORE=1,279 SQ.FT.
 NEW PIZZA PIZZA ADDITION=1,266 SQ.FT.
 NEW PIZZA PIZZA STORE AREA=2,929 SQ.FT.

NOTES:

1. CONTRACTOR IS TO VERIFY ALL DIMENSIONS ON SITE PRIOR TO COMMENCING WITH CONSTRUCTION.
2. OIL STORAGE SYSTEM TO BE IN PLACE & OPERATIONAL BY THE OPENING OF THE STORE.

KING STREET WEST

General Notes

DRAWINGS MUST NOT BE SCALED.
 CONTRACTOR MUST CHECK AND SITE VERIFY ALL DIMENSIONS AND REPORT ANY DISCREPANCIES TO THE DESIGNER PRIOR TO PROCEEDING WITH THE WORK.
 ALL WORK SHALL COMPLY WITH THE LAWS AND REGULATION OF AUTHORITIES HAVING JURISDICTION TO THIS SITE.
 ALL WORK SHALL CONFORM TO PIZZA PIZZA SPECIFICATIONS FOR GENERAL CONDITIONS, MATERIALS AND WORKMANSHIP.
 THIS DRAWING IS TO BE READ IN CONJUNCTION WITH ALL OTHER DRAWINGS AND THE TENANT/LANDLORD AGREEMENT WITH REFERENCE TO THIS STORE.

No.	Date	Description	Seal
1.	NOV. 30/01	ISSUED FOR BLDG. PERMIT	



580 Jarvis Street
 Toronto, Ontario
 M4Y 2H9

Tel. (416) 967-1010
 Fax. (416) 967-6449

Designed by
 STEVE GILCHRIST

Checked by
 HOWARD TUCHMAN

Scale:
 1/8"=1'-0"

Store Area:
 2,929 SQ.FT.

Date:
 NOV. 12, 2001

Project Name

PIZZA PIZZA #89

Project Location

375 KING STREET WEST
 OSHAWA, ONTARIO

Sheet No.

Drawing's Title

EQUIPMENT PLAN

A5